

PAJERO SPORT

QUICK GUIDE



**MITSUBISHI
MOTORS**

A few tips to get you started!

Contents

2.	A few tips to get you started
3.	Starting the Vehicle
5.	Around the Centre Console
7.	4WD Systems
8.	Around the Steering Wheel
11.	Power Tailgate
12.	Mitsubishi Smartphone Application
13.	Smartphone Link Display Audio (SDA) Screen Overview
14.	SDA Connections and Quick Tips
15.	Advanced Safety Systems

This quick guide has been prepared to help you enjoy safe and comfortable driving.

This quick guide is a short version of the owner's manual. For more details, please refer to the owner's manual.

This quick guide covers a range of specifications and manufacturer's options, so some of the descriptions may not apply to your Pajero Sport model.

Congratulations on purchasing your new PAJERO SPORT **Here are a few important things you need to know:**

1. Your vehicle takes Diesel fuel, available at any service station.
2. Your first service is at 1,500km or within one month. But don't worry if you forget, we'll be in contact to remind you!
3. Only have your Pajero Sport serviced by a recognised Mitsubishi Motors dealer, for a list of dealers visit mmnz.co.nz/find-a-dealer/

Wherever your road takes you, we'll be right there with you. It's part of our commitment to ensuring you enjoy complete driving pleasure. Nothing demonstrates this commitment better than our unique Diamond Advantage package.

Mitsubishi's Diamond Advantage combines our 10-year or 160,000km (whichever occurs first) Powertrain Warranty*, a 5-year or 130,000km (whichever occurs first) new vehicle warranty* and 5-years roadside assist, to cover you in the unlikely event of a breakdown*.

*Please refer to your warranty booklet for full terms and conditions.

10 | **5**
YEAR | **YEAR**
DIAMOND
ADVANTAGE

Starting the Vehicle

Keyless Operation System (push button start)

The keyless operating system allows you to lock and unlock the doors, start the engine and change the operation mode simply by carrying the keyless operation key with you.

- Step 1** Make sure the parking brake is applied
- Step 2** Press and hold the brake pedal down firmly
- Step 3** Make sure the selector lever is in the "P" (PARK) position
- Step 4** Press the engine Start/Stop switch
- Step 5** Make certain that all warning lamps are functioning properly



ACC Mode:

ACC mode allows electrical devices such as audio and accessory sockets to operate.

You can put the vehicle in ACC mode from "OFF" by pushing the Start/Stop engine button once without your foot on the brake pedal.

After approximately 30 minutes has elapsed with the operation mode in ACC, the function automatically cuts out the power for the audio system and accessory sockets.



Multi-information Display



The multi-information display shows warnings and information critical to the vehicle. The display can be changed using the multi-information display controls located on the steering wheel.

The display can show the following screens:

- Trip computer information
- Vehicle settings
- Cruise control system information
- Audio information
- Driver assistance
- Warning information
- ECO information
- Other information (such as language and units)

Starting the vehicle

Instrument Cluster

1. Engine coolant temperature display
2. 8 inch digital driver display
3. Fuel remaining display
4. Rheostat illumination button

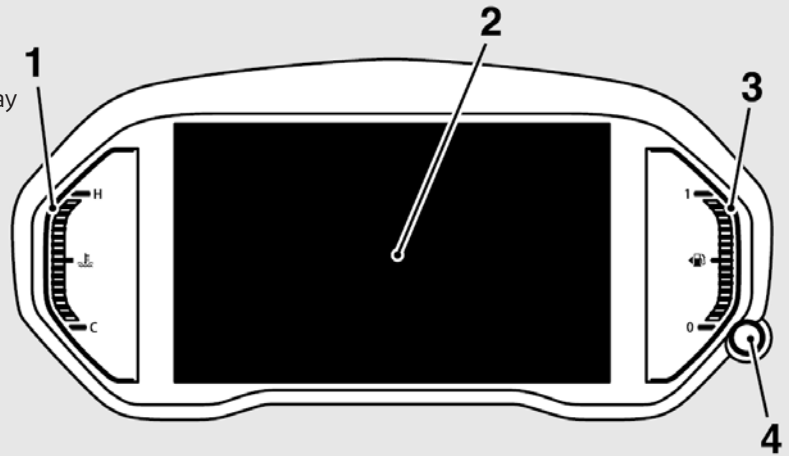

Two types of screen displays can be displayed on the digital driver display.

To change the display type, use the multi-information display controls to select "Settings" → "Display Type" then press "Enter"

Type 1

1. Digital speedometer
2. Digital tachometer
3. Multi-information display
4. Current speed display
5. 4WD drive mode indicator display
6. Selector lever position display
7. Odometer



Type 2

1. Current speed display
2. Digital tachometer
3. Multi-information display
4. 4WD drive mode indicator display
5. Selector lever position display
6. Odometer



Around the Centre Console



1. Selector Lever

P (Park)	Locks the transmission to prevent the vehicle from moving.
R (Reverse)	The vehicle moves in reverse.
N (Neutral)	The transmission is disengaged and no drive is sent to the wheels, which are not locked either.
D (Drive)	The vehicle moves forward.
Sports Mode (+/-)	You can use sports mode to manually adjust the gear ratio of the vehicle. For more information, please refer to page 8 of the quick guide.

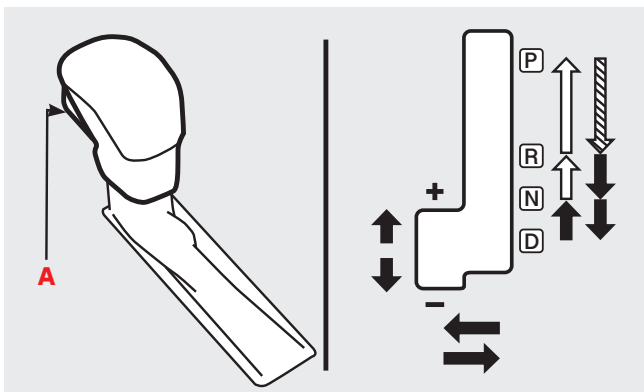

A: Lock Button

	The lock button must be pressed while the brake pedal is depressed to move the selector lever.
	The lock button must be pressed to move the selector lever.
	The lock button does not need to be pressed to move the selector lever.

2. Electric Parking Brake

Bring the vehicle to a complete stop and pull the switch up to lock the wheels when you are parking. The indicator lamp on the switch illuminates in red.

3. Brake Auto Hold Switch

The Brake Auto Hold function maintains the braking force without the driver having to depress the brake pedal when the vehicle is stopped at a traffic light or intersection. As soon as the driver depresses the accelerator pedal again, the Brake Auto Hold function is deactivated and the braking force is released.

4. Super Select II

Changes the operation of the 4WD system. For more information, please refer to page 7 of the Quick Guide.

5. Hill Descent Control

Assists steady driving down sharp off road gradients. For more information please refer to page 7 of the Quick Guide.

6. Off-Road Modes

Changes characteristics of the engine and off road system to suit different road conditions. For more information, please refer to page 7 of the Quick Guide.



Around the Centre Console



Air Conditioning (AC) Settings

1. Air conditioning switch
2. Passenger's side temperature control dial
3. AUTO switch (keeps a constant set temperature by controlling the fan speed and air flow distribution)
4. Driver's side temperature control dial
5. Rear fan switch
6. MODE switch
7. Front window demister switch
8. Blower speed selection switch
9. SYNC switch (syncs driver's & passenger's side temperature)
10. Rear window demister switch (also turns on side mirror demisters)
11. Air recirculation switch
12. OFF switch
13. Driver and front passenger heated seat switches





4WD Systems

- 1 - Super Select II
- 2 - Hill Descent Control
- 3 - Off-Road Modes

1. Super Select II

Shifting to rear-wheel drive or 4-wheel drive can be made by operating the Super Select dial.

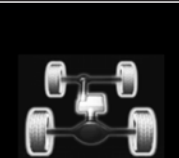
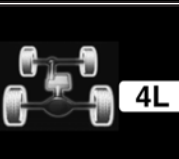
4WD selector position		4WD indicator and 2WD/4WD operation display	Driving conditions
2H	Rearwheel drive		When driving economically on dry paved roads. Runs with rear-wheel drive.
4H	Fulltime 4-wheel drive		When driving on paved roads or slippery roads in any conditions. Runs with 4-wheel drive.
4HLc	4WD high range with centre differential lock engaged		When driving on rough sand or snow covered roads.
4LLc	4WD low range with centre differential lock engaged		When driving up or down steep hills, on rough or muddy roads (especially when increased torque is required).

NOTE: Do not drive the vehicle in 4HLc or 4LLc on paved roads.

Quick Tip: The vehicle must be stationary and the gear shift lever must be in "N" (neutral) to change into 4LLc. You can change between 2H, 4H and 4HLc while driving up to 100km/h.



2. Hill Descent Control

Hill Descent Control (HDC) is a system that helps maintain a constant speed when descending steep gradients, making it easier to control deceleration when engine braking alone is insufficient. To operate this system:

- 1 - Bring the vehicle to a complete stop.
- 2 - Place the gearshift lever into "D" or "R"
- 3 - Press the HDC button (2)
- 4 - Make sure that the HDC indicator lamp comes on.

The system will now control the braking of the vehicle down the hill. You can change the controlled speed by operating the accelerator or brake pedal (up to speeds of 25km/h).

3. Off-Road Modes

The off-road modes selector is a function that helps enhance driving performance, and vehicle stability over a wide range of driving styles and conditions. The off-road modes will change characteristics of the engine, transmission and brake control to suit the road surface conditions. Certain off-road modes are only available in certain Super Select II modes.

See below for the list of off-road modes available.

GRAVEL 4HLc or 4LLc	MUD/SNOW 4HLc or 4LLc	SAND 4HLc or 4LLc	ROCK 4LLc
			
Secure driving with good grip on flat unpaved roads or wet paved roads.	Powerful & confident driving on mud and deep snow.	Powerful & confident driving on sand.	Powerful & confident driving on rocky and bumpy surfaces, easy to get out from being stuck.

Around the Steering Wheel



1. Audio controls
2. Multi-information display controls
3. Adaptive Cruise Control/Speed Limiter "RES+/"SET-" switch
4. Adaptive Cruise Control distance switch
5. Speed Limiter On/Off switch
6. Adaptive Cruise Control On/Off switch
7. Multi Around View Monitor button (displays the different available camera views on the SDA screen)
8. Handsfree phone controls

Shift Paddles (Sports Mode)

You can use the shift paddles (sport mode) to manually adjust the gear ratio of the vehicle. In manual shift mode, the shift range is displayed on the multi-information display.

Shifting with shift lever

Whether the vehicle is stationary or in motion, sports mode can be selected by pushing the selector lever from the D (Drive) position into the manual gate (A). To return to the D position, push the selector lever back into the main gate (B).

In sports mode, gear shifts can be made by simply by moving the selector lever up (+) to increase by one gear or down (-) to decrease by one gear.

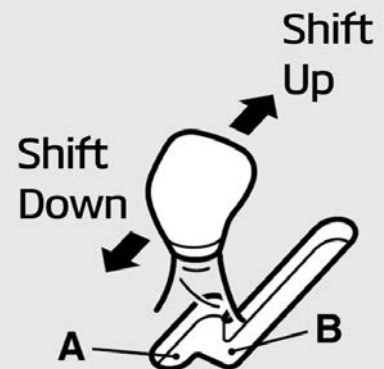

Shifting with shift paddles

Using the shift paddles, you can shift into sports mode even when the selector lever is in the main gate.

+ (Shift Up) - The transmission shifts up one gear by each operation.

- (Shift Down) - The transmission shifts down one gear by each operation.

To return to the D (Drive) position using the shift paddles, pull the + (Shift Up) shift paddle forward (towards the driver) for over 2 seconds.

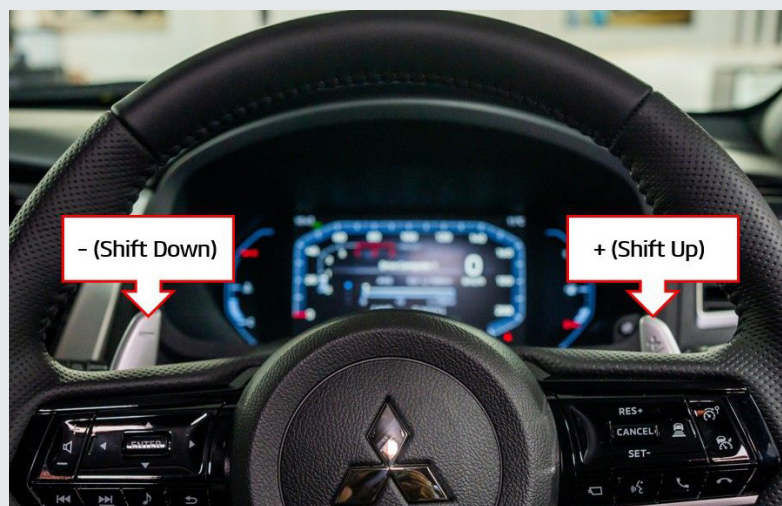

Around the Steering Wheel

Multi Around View Monitor



The Multi Around View Monitor is a system that combines the views from four cameras and displays them on the Smartphone-link Display Audio screen. It helps drivers park their vehicle in parking spaces and to parallel park.

When the switch on the steering wheel is pressed, the both-sides view/front-view mode is displayed on the SDA. Each time the switch is pressed, the camera view changes.



Windscreen Wiper (left steering wheel stalk)

Rotate the stalk to change the windscreen wiper function.

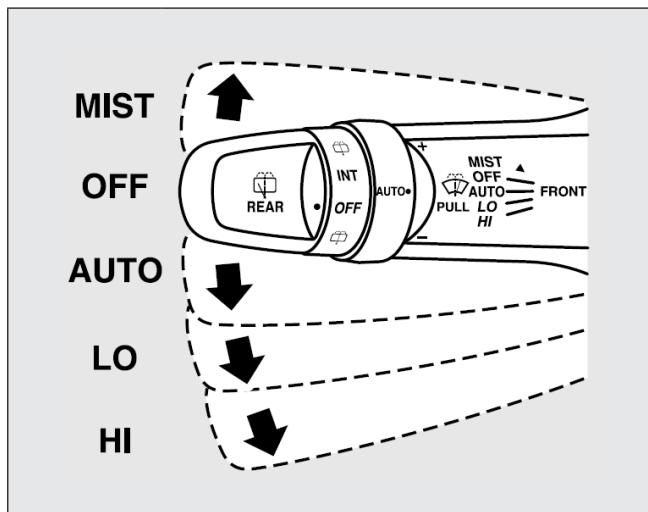

Mist	Misting function The wipers will operate once.
OFF	Off
AUTO	The wipers will automatically operate depending on the degree of wetness on the windscreen.
LO	Slow
HI	Fast

Quick Tip: You can adjust the sensitivity of the windscreen wipers when they are in "AUTO" mode by rotating the "AUTO" ring; turn it up to increase sensitivity and down to decrease sensitivity.

Headlamps (right steering wheel stalk)

Rotate the switch to turn on the lamps.

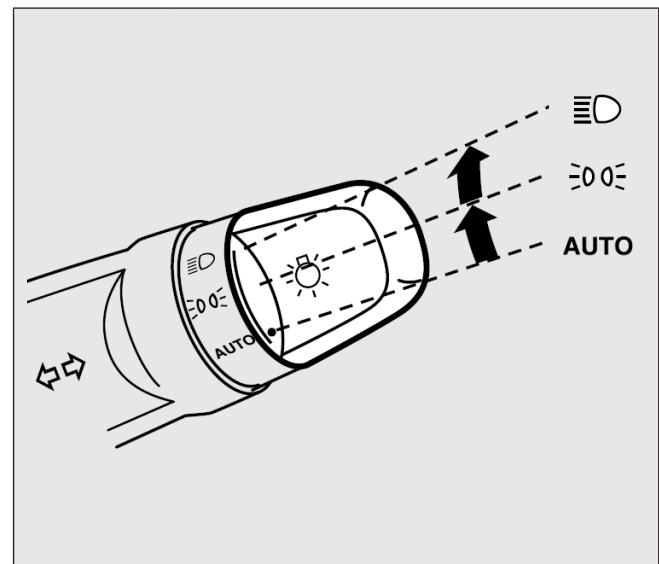

	Headlamps and other lamps come on.
	Position, parking, tail, license plate, and instrument panel lights will turn on.
AUTO	When the ignition is turned ON, the headlamps, front parking, tail, license plate, and instrument panel will turn on and off automatically in accordance with the outside light level. All lamps will turn off automatically when the ignition is turned off.

Around the Steering Wheel



Other Buttons

(Located to the right-hand side of the steering wheel)

1	Active Stability & Traction Control	The Active Stability Control function is automatically activated when the engine is turned ON. You can deactivate the system by pressing down the "ASC OFF" switch for 3 seconds or longer.
2	Parking Sensor Button (SONAR)	Turns parking sensors off.
3	Forward Collision Mitigation settings	This switch is used to turn on and off the FCM and also to select your desired collision alarm timing. When the switch is held pressed, the ON/OFF state of the FCM changes from ON to OFF and vice versa. If you give the switch a short press with the FCM in the ON state, you can check the current alarm timing and also change the collision alarm timing.

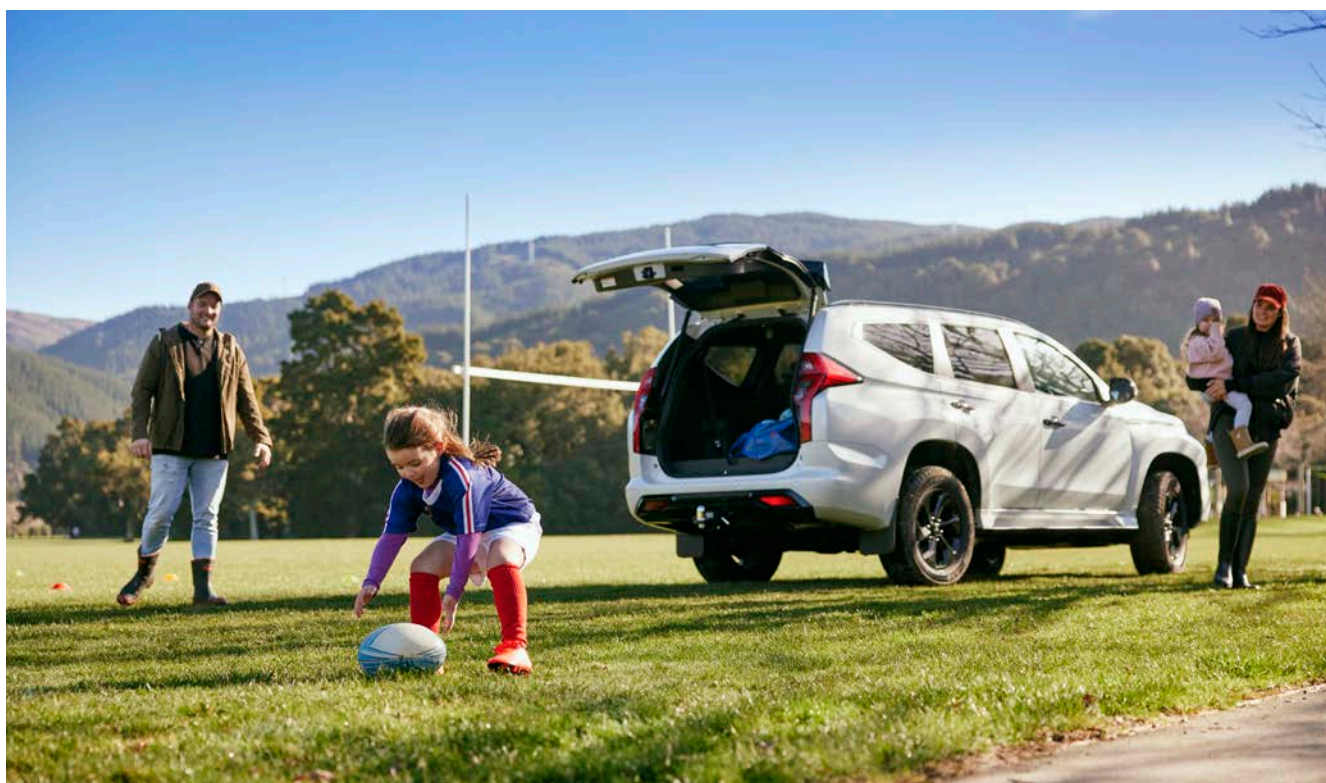

Power Tailgate

The tailgate can be opened or closed automatically by:

- A** Pushing the power remote tailgate switch on the instrument panel for more than 1 second.
- B** Pushing the power remote tailgate button twice quickly on the key.
- C** Pushing the tailgate opener switch when the tailgate is unlocked.
- D** Pushing the power remote tailgate close switch on the lower part of the tailgate.
- E** Pushing the power tailgate close and lock switch located on the lower part of the tailgate will close the tailgate and lock the vehicle.
- F** The kick motion sensor on the corners of the rear bumper enables you to open the and close the tailgate handsfree. When you move your foot under and away from the operating range similarly to a kicking motion, the tailgate will open or close automatically.
- G** Through the Mitsubishi Remote Smartphone Application. (See page 12 of the quick guide)

Quick Tip: You can set the tailgate to open to a specific height by performing the following:

1. Open the tailgate.
2. Pull and hold the tailgate to the desired height.
3. While holding the tailgate at the desired height, press and hold the remote tailgate close switch (D) for approximately 3 seconds or until the buzzer makes a sound.



Next time you operate the power tailgate function, the tailgate will open to the set height.

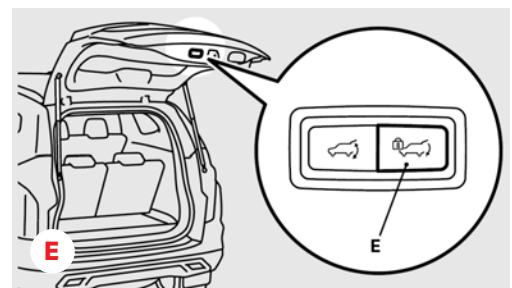
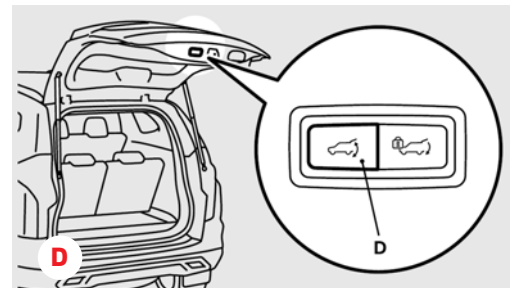
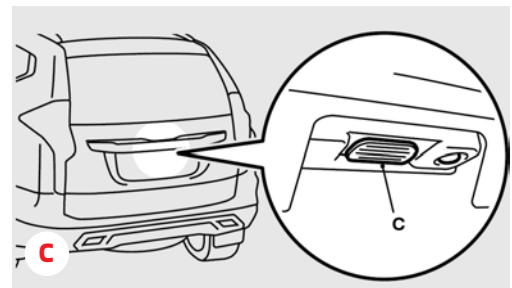
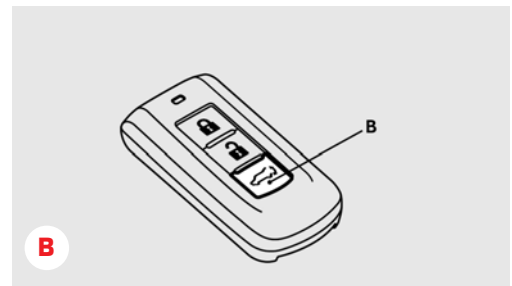
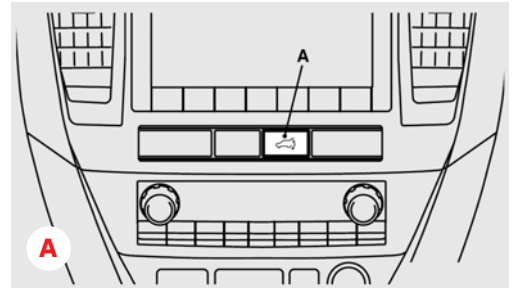

Mitsubishi Remote Smartphone Application

To register Bluetooth devices:

1. Set Bluetooth to ON, and start the Mitsubishi Remote Control App.
2. Operate the digital driver display switches to switch the multi-information screen to the "Settings" display.
3. Select "Remote".
4. Select "Device Registration" and press and hold the Enter switch for 2 seconds or more to display the passkey on the multi-information screen.
5. Enter the passkey on the multi-information screen to your Bluetooth device.
6. When registration is completed, "Success" will be displayed on the multi-information screen.



To learn more, please scan the QR code.

Tailgate Operation

To open or close the power tailgate, press and hold the OPEN/CLOSE button. If the tailgate is completely opened or closed, a check mark will be displayed.



Tailgate Reservation

Open reservation

When you reserve OPEN and approach the tailgate, it opens automatically.



Close reservation

When you reserve CLOSE and go away from the tailgate, it closes automatically.



Vehicle Status

You will be informed about operations missed while exiting your vehicle through notifications.

If you forget to lock or turn off the lamp and leave the vehicle, a notification will be sent to your Bluetooth device.



Wearable Device-link

Using motion settings, you can operate functions set in advance by shaking the arm while the app is running in the foreground.

1. Tailgate reservation
2. Tailgate operation
3. Car finder (headlamp on operation)
4. Vehicle status (lock operation)
5. Motion setting



Car Finder

You can be informed about the vehicle location when it is difficult to find the vehicle at night or in a parking lot.

Using the app, you can turn on the vehicles headlights to help locate the vehicle.

The headlights will be turned off automatically after 30 seconds.



Fuel Consumption

You can check the fuel consumption information, cruising range, and green driving score by scrolling up and down.

1. Average fuel consumption/Cruising range
2. Green Driving Score
3. Short term fuel consumption
4. Long term fuel consumption
5. Green driving score history



Smartphone Link Display Audio (SDA) Screen Overview

- 1. Home Screen
- 2. Multimedia
- 3. Audio Hands Free Phone

- 4. Settings
- 5. Info
- 6. Android Auto/Apple Car Play



For further information on the various SDA screens, refer to your owner's manual.

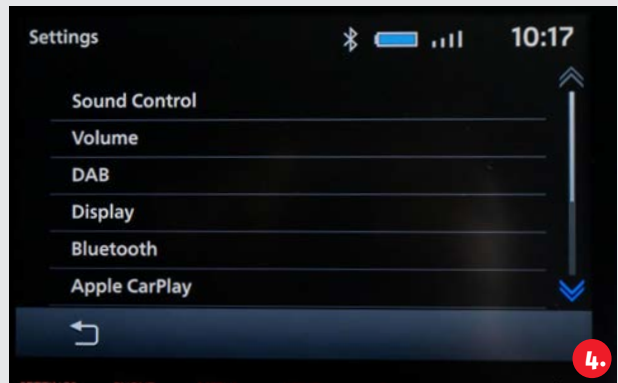

Allows you to check various setting screens such as connections or sound settings.



Allows playback using radio or various other media.

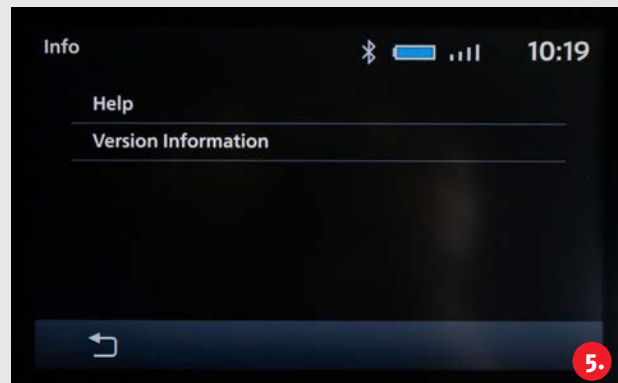

Allows you to check information such as system information and notifications

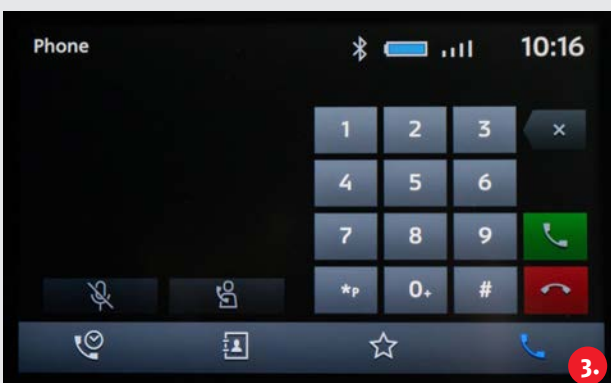

Connecting your mobile phone with Bluetooth lets you use the hands-free phone system.

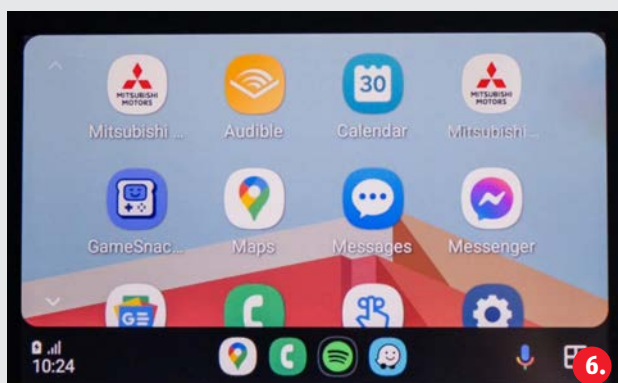

Android Auto/Apple CarPlay can be used by connecting a compatible phone via a USB cable or Bluetooth.



SDA Connections and Quick Tips

How do I connect a compatible smartphone via Bluetooth?

1. Display the "Settings" menu on the SDA screen
2. Press "Bluetooth"
3. Tap "Device Management"
4. Select the search icon and follow the on screen instructions

How do I make a call when phone is connected via Bluetooth?

1. Once your phone has been connected to Bluetooth, press "Phone" on the SDA screen
2. Select from the options such as, "Contacts", "Favourites", "Call History" or "Telephone Keypad"
3. Select the contact you wish to call, then press "dial"

How do I select a Bluetooth device once connected?

1. Once your phone has been connected to Bluetooth, press "Settings" on the SDA screen.
2. Select "Bluetooth"
3. Tap "Device Management"
4. Tap the name of the device you wish to connect by either selecting handsfree phone (select phone icon), media (select music icon) or both (select both)

Apple CarPlay/Android Auto

Plug in your compatible Apple or Android phone via USB and follow the on screen instructions selecting either:

1. Enable this time – this will enable Apple CarPlay/Android Auto for one time then will ask again
2. Always enable - this will enable Apple CarPlay/Android Auto each time your phone is connected



To display Apple CarPlay/Android Auto screen:

1. Select the "Home Button"
2. Select either "Apple Carplay" or "Android Auto"

Quick Tip: In the "Bluetooth" screen, you can connect one phone to Bluetooth music and one phone to Handsfree phone by selecting the media/phone icon the SDA screen for the two different Bluetooth connections.



Advanced Safety Systems

Advanced Safety System	Description	How to adjust/turn system on/off
<p>Forward Collision Mitigation (FCM)</p> 	<p>If the system judges that there is a high risk of your vehicle colliding with a vehicle in front, the system applies the automatic brakes moderately to encourage you to apply the brakes. If the system judges that a collision is unavoidable, it initiates emergency braking control to mitigate collision-caused damages or, if the situation permits, to avoid a collision. When the emergency braking control is triggered, you are warned of the hazard with visual and audible alarms. Once the emergency braking has worked, you are alerted by a message on the information screen of the instrument cluster.</p>	<p>To turn the system ON or OFF press the FCM button to the right of the steering wheel. When the switch is held pressed, the ON/OFF state of the FCM changes from ON to OFF and vice versa. This switch is also to select your desired collision alarm timing. If you give the switch a short press with the FCM in the ON state, you can check the current alarm timing and also change the collision alarm timing.</p>
<p>Ultrasonic misacceleration Mitigation System (UMS)</p> 	<p>The system operates to prevent sudden starts and mitigate collision-caused damages, by suppressing the engine output for up to approximately 5 seconds when the system judges that the accelerator pedal was depressed promptly and too strongly, such as misoperation of it. This system operates when the vehicle is at a stop or is moving backward at less than approximately 10km/h. When the Ultrasonic misacceleration Mitigation System operates, a warning display appears on the information screen of the instrument cluster, and a buzzer sounds intermittently.</p>	<p>Ultrasonic misacceleration Mitigation System ON/OFF is switched in conjunction with the ON/OFF state of the Forward Collision Mitigation.</p> <p>To turn the system off or on, press the FCM button to the right of the steering wheel. When the switch is held pressed, the ON/OFF state of the FCM and UMS changes from ON to OFF and vice versa.</p>

Advanced Safety Systems

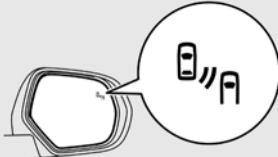
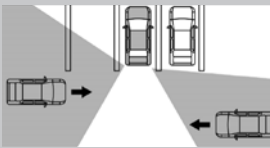
Advanced Safety System	Description	How to adjust/turn system on/off
<p>Blind Spot Warning (with lane change assist)</p> 	<p>The Blind Spot Warning (BSW) is a driving aid system that alerts the driver when another vehicle which may not be visible through the outside rear-view mirror is travelling in the next lane behind your vehicle. If the radar sensors detect a vehicle in the detection zone, the BSW indicator lamp illuminates. If the turn signal is then activated, the system chimes three times and the BSW indicator lamp flashes. The BSW indicator lamp continues to flash until the detected vehicle leaves the detection zone.</p>	<p>Operate the digital driver display switches to switch the information screen to the menu screen. Select "Driver Assistance", then press the Enter switch. Select the "BSW" and press the Enter switch to select ON or OFF.</p> <p>If you turn the BSW ON or OFF, the Rear Cross Traffic Alert (RCTA) also turns ON/OFF at the same time.</p>
<p>Rear Cross Traffic Alert (RCTA)</p> 	<p>The Rear Cross Traffic Alert (RCTA) system can help alert the driver when the vehicle is reversing. The system is designed to detect other vehicles approaching from the right or left of the vehicle. If the system detects cross traffic, a chime will sound and the BSW indicator lamp flashes on the side the vehicle is approaching from. A warning message will also appear on the information screen on the instrument cluster.</p>	<p>To turn the RCTA safety system ON or OFF, operate the digital driver display switches to switch the information screen to the menu screen. Select "Driver Assistance", then press the Enter switch. Select "BSW" and press the Enter switch to select ON or OFF.</p>

www.mmnz.co.nz

08/2024

